



SPECIAL EVENT PERMIT

2015-11

All fees have been paid in full as required by this permit. This special event permit shall expire and be null and void at the conclusion of the event, if any conditions herein are breached, or if the permit is transferred to any other person, corporation, organization, or entity.

EVENT INFORMATION

Event Name: Cow A Bunga Race
Applicant: Jeff Young
Phone: 435-232-8056
Email: jeffyoung.y@gmail.com

Event Date(s): 16 May 2015
Event Type: Race
Promoting Entity: Richmond City Corporation

[Handwritten signature]

15 MAY 2015

Approved by: Director of Development Services Date

CONDITIONS OF APPROVAL

- 1. All participants and volunteers shall comply with County Ordinance §8.40 governing special events.
2. As necessary, event organizers, staff, participants, and spectators must allow access for emergency vehicles in the case of a wildland fire.

AGREEMENT OF ACCEPTANCE

As the applicant for the special event described above, I hereby agree to comply with all Federal, State, and County laws, ordinances, and regulations before, during and after the event. I further agree to indemnify and save harmless Cache County, its officers, agents, and employees from and against any and all claims resulting from the use of the premises by the Applicant, the Applicant's invitees, licensees, agents and employees. I agree to permit law enforcement personnel the free and unrestricted access to and upon the premises at all times during the event for all lawful and proper purposes not inconsistent with the intent of the permit.

I understand and agree that this permit may be revoked upon breach of any of the conditions herein or at the discretion of the authorized officer. I understand that this permit is not transferable and agree not to transfer my permit to any person, corporation, organization or other entity, and is only valid within the unincorporated county.

In Accordance with Title 8 Section 8.40 of the Cache County Ordinance, I hereby submit and certify that the above information provided is accurate and complete to the best of my knowledge.

[Handwritten signature]

5/15/15
Date

Accepted by: Applicant

**COMPLIANCE INFORMATION
RICHMOND CITY SPECIAL EVENT
COWABUNGA RACE - 1 MILE, 5 KILOMETER, 12 KILOMETER
SATURDAY, MAY 16, 2015 STARTING AT 8:00 A.M.**

3. SPONSORS:

CHERRY PEAK RESORT - John Chadwick 435-625-1822

CASPERS ICE CREAM - BIG BOY - Jeff Young 435-232-8056

4. Attached

5. PARTICIPATION: ESTIMATE 100 STAFF, PARTICIPANTS, AND SPECTATORS (As of May 1st, only twelve have signed up.)

6. EXISTING PUBLIC HEALTH FACILITIES ARE ADEQUATE.

7. Attached.

8. EMT'S AND FIRE PERSONNEL ARE ON ALERT FOR THE ENTIRE BLACK & WHITE DAYS PERIOD - MAY 12TH THROUGH 16TH. NO SPECIAL NOTIFICATION IN REQUIRED.

9. NO ADDITIONAL LAW ENFORCEMENT SERVICES ARE REQUIRED FOR THIS EVENT.

10. FEE IS \$7.00 PER RUNNER OR \$30.00 FOR A FAMILY

CERTIFICATE OF INSURANCE

Issue Date

5/1/15

Producer
Utah Local Governments Trust
55 South Highway 89
North Salt Lake UT 84054

THIS CERTIFICATE IS ISSUED AS A MATTER OF INFORMATION ONLY AND CONFERS NO RIGHTS UPON THE CERTIFICATE HOLDER. THIS CERTIFICATE DOES NOT AMEND, EXTEND OR ALTER THE COVERAGE AFFORDED BY THE POLICIES BELOW.

Insured
Richmond City
6 West Main Street
Richmond UT 84333

COMPANIES AFFORDING COVERAGE	
Company A	<i>Utah Local Governments Trust</i>
Company B	
Company C	
Company D	

COVERAGES

THIS IS TO CERTIFY THAT THE POLICIES OF INSURANCE LISTED BELOW HAVE BEEN ISSUED TO THE INSURED NAMED ABOVE FOR THE POLICY PERIOD INDICATED, NOTWITHSTANDING ANY REQUIREMENT, TERM OR CONDITION OF ANY CONTRACT OR OTHER DOCUMENT WITH RESPECT TO WHICH THIS CERTIFICATE MAY BE ISSUED OR MAY PERTAIN, THE INSURANCE AFFORDED BY THE POLICIES DESCRIBED HEREIN IS SUBJECT TO ALL THE EXCLUSIONS AND CONDITIONS OF SUCH POLICIES, LIMITS SHOWN MAY HAVE BEEN REDUCED BY PAID CLAIMS.

Code	TYPE OF INSURANCE	POLICY NUMBER	POLICY EFFECTIVE	POLICY EXPIRATION	ALL LIMITS
A	General Liability Claims Made Occurrence <input checked="" type="checkbox"/>	13180-GL2014	7/1/14	7/1/15	General Aggregate \$5,000,000
A	Auto Liability Any Auto <input checked="" type="checkbox"/> All Owned Autos Scheduled Autos	13180-GL2014	7/1/14	7/1/15	Combined Single Limit \$5,000,000 Bodily Injury per Person Bodily Injury per Accident Property Damage
	Workers' Compensation and Employers' Liability				Statutory As Per Utah Law
	Auto Physical Damage				Deductible Comprehensive Collision
A	Property	ULGT-APDP-2010	7/1/14	7/1/15	Deductible \$1,000.00 Coverage SPECIAL FORM
	Other				

DESCRIPTION

Confirmation of General/Auto Liability Coverage and Property Coverage for Richmond Town in regards to the Black and White Days May 2015.

CERTIFICATE HOLDER

Cache County
179 N Main
Logan UT 84321

CANCELLATION

SHOULD ANY OF THE ABOVE DESCRIBED POLICIES BE CANCELLED BEFORE THE EXPIRATION DATE THEREOF, THE ISSUING COMPANY WILL ENDEAVOR TO MAIL 10 DAYS WRITTEN NOTICE TO THE CERTIFICATE HOLDER NAMED TO THE LEFT, BUT FAILURE TO MAIL SUCH NOTICE SHALL IMPOSE NO OBLIGATION OR LIABILITY OF ANY KIND UPON THE COMPANY, ITS AGENTS OR REPRESENTATIVES.

AUTHORIZED REPRESENTATIVE



Steven A Hansen, CEO



A Google Maps feature used on this page is ch

To see all the details that are visible on the screen, use the "Print" link next to the map.

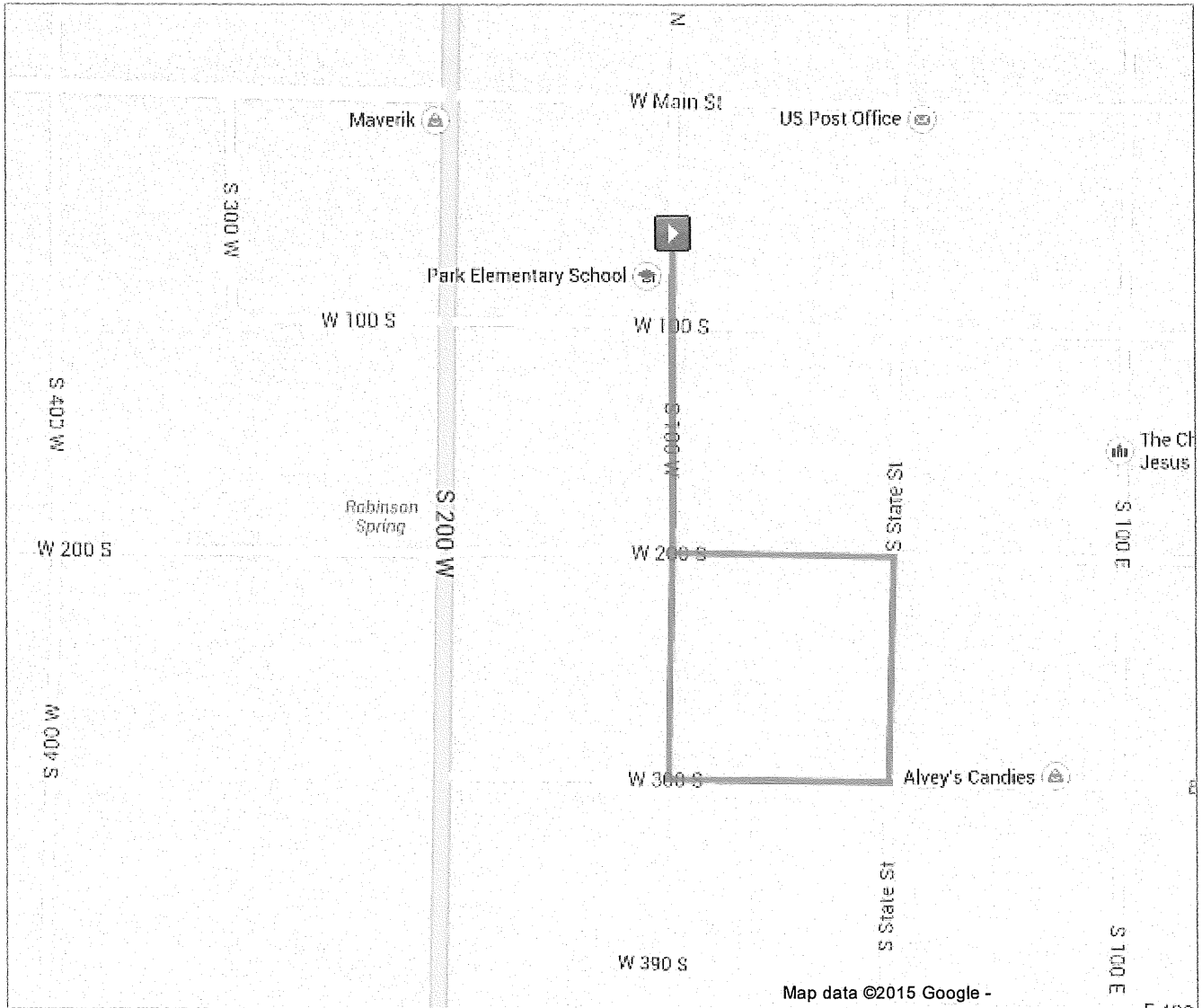
migrated. [Learn more](#) [Dismiss](#)



Displaying content from www.mapmyfitness.com

The content displayed below and overlaid onto this map is provided by a third party, and Google is not responsible for it. Information you enter below may become available to the third party.

Contents

 Cowabunga Mile

Cowabunga Mile

COWABUNGA RACE - 1 MILE



A Google Maps feature used on this page is ch

To see all the details that are visible on the screen, use the "Print" link next to the map.

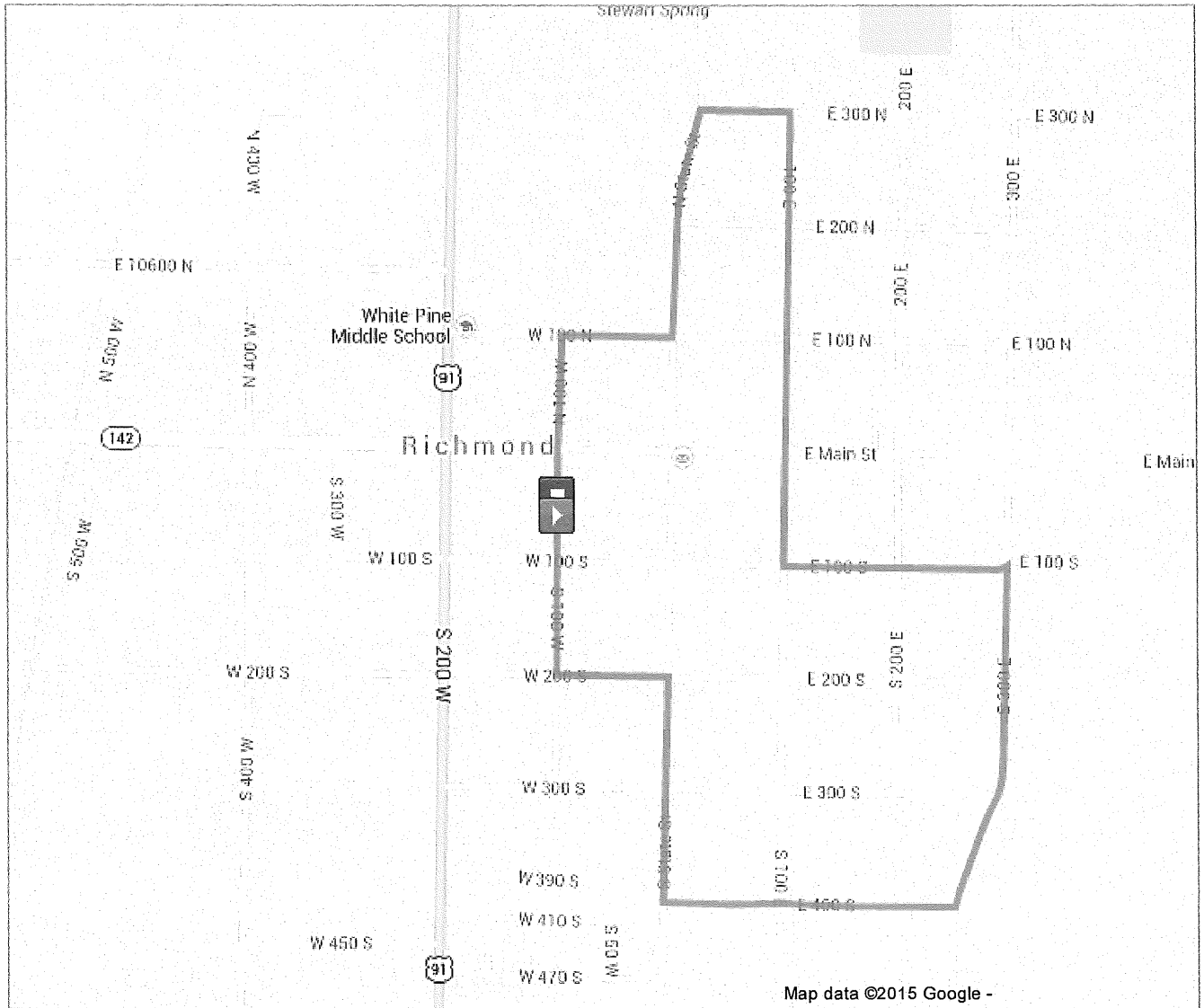

migrated. [Learn more](#) [Dismiss](#)



Displaying content from www.mapmyfitness.com

The content displayed below and overlaid onto this map is provided by a third party, and Google is not responsible for it. Information you enter below may become available to the third party.

Contents

-  Cowabunga Ideal!!
-  Cowabunga Ideal!!
- Cowabunga Ideal!!

COWABUNGA RACE - 5 KILOMETER



A Google Maps feature used on this page is ch

To see all the details that are visible on the screen, use the "Print" link next to the map.

migrated. [Learn more](#) [Dismiss](#)

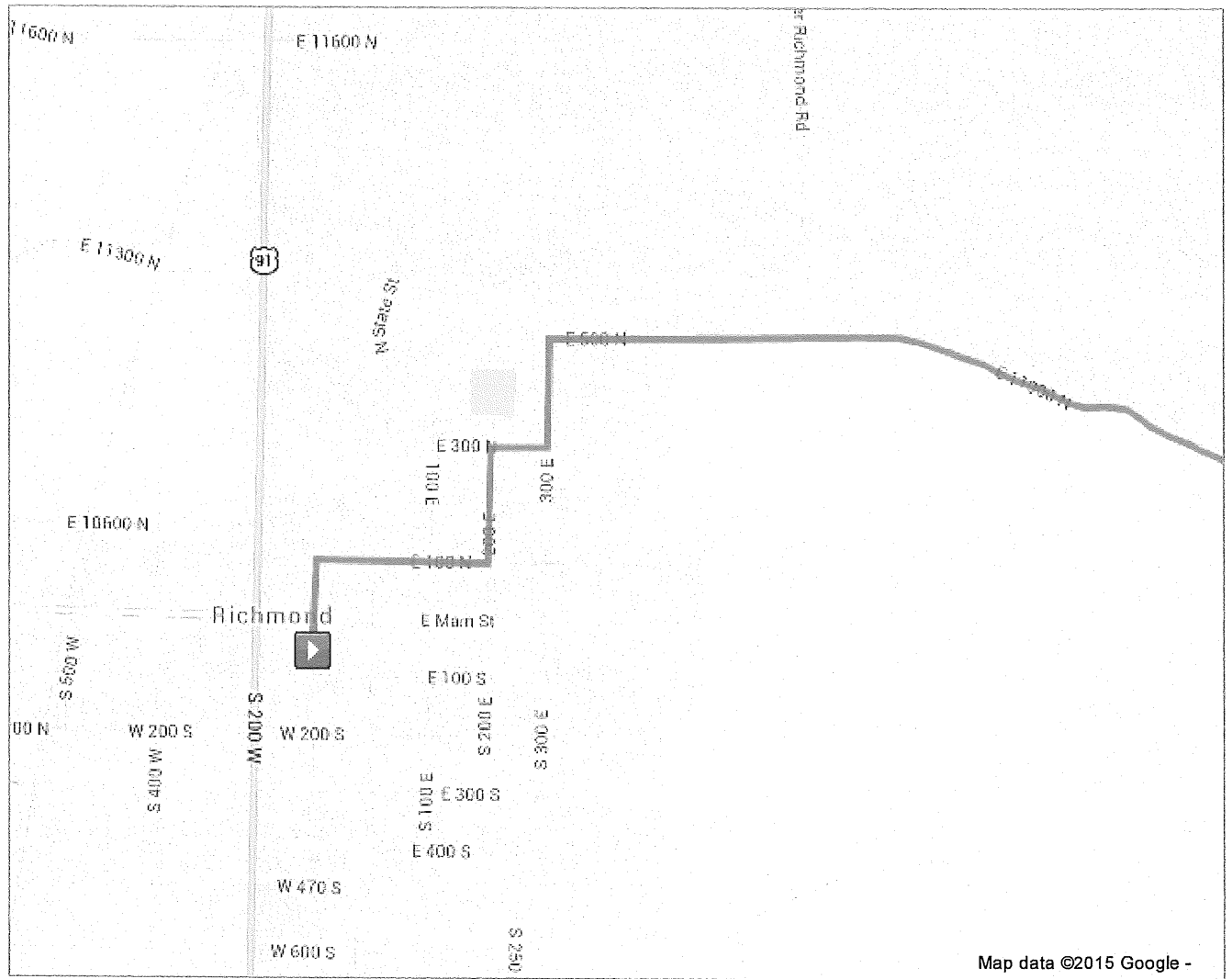

Map data ©2015 Google -

Displaying content from www.mapmyfitness.com

The content displayed below and overlaid onto this map is provided by a third party, and Google is not responsible for it. Information you enter below may become available to the third party.

Contents

-  Cherry Peak Race (12K=7.46 Mi)
- Cherry Peak Race (12K=7.46 Mi)

COWABUNGA RACE - 12 KILOMETER